



AOM SPRAY EQUIPMENT

5005 SANBUSCO DR. NE
RIO RANCHO, NM 87144
PHONE: 505-867-1946
FAX: 505-867-1948

2 1/2 QT REMOTE PRESSURE POT

75-111

Single regulator
(Dual regulated available)
Safety relief valve
Handle
Lightweight
Screw type top



OPERATION:

Connect hose as shown in diagram.

Fill cup with strained fluid mixed in accordance with manufacturer's recommendations on label of container.

Fasten cover securely.

Set air pressure at oil and water extractor (transformer) to between 35 and 80 P.S.I., depending upon atomization desired.

Set regulator on pressure cup to approximately 5 P.S.I. for enamels: 3 P.S.I. for lacquers.

(Turn knob clockwise to increase pressure: to reduce pressure, turn knob counter-clockwise. Always release air in cup by momentarily opening air release valve on cover when attempting to reduce pressure)

Open air adjusting valve.

With trigger fully pulled back, make several fast spray strokes against a flat surface. After adjustment of pressure, proper atomization will be indicated by an even distribution of finely divided paint particles.

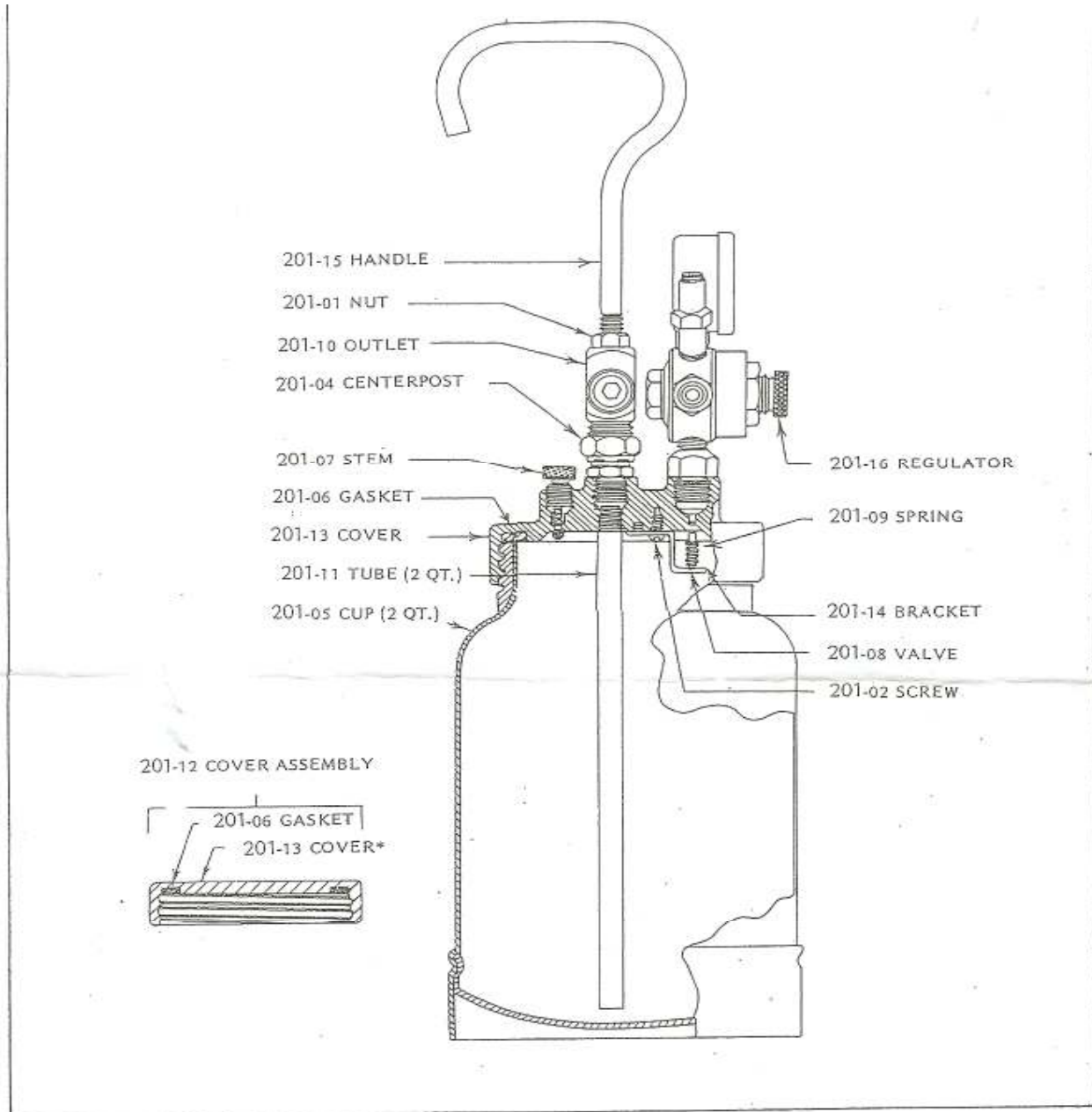

Ref. No.	Part No.	Description	Qty.	Ref. No.	Part No.	Description	Qty.
1	201-01	5/16 Hex Jam Nut	1	9	201-09	Check Valve Spring	1
2	201-02	No.6-32 x 1/4 Rd. Hd. M. Screw	1	10	201-10	Fluid Outlet	1
4	201-04	Center Post Assembly	1	11	201-11	Fluid Tube (2 Qt.)	1
5	201-05	Cup (2 Qt.)	1	12	201-12	Cover Assembly	1
6	201-06	Cover Gasket (Rubber)	1	13	201-13	Container Cover	1
7	201-07	Relief Valve Stem	1	14	201-14	Check Valve Bracket	1
8	201-08	Check Valve	1	15	201-15	Handle	1
			1	16	201-16	Regulator Assembly	1

Complete regulator assembly Part # REG-111
 Gauge Only Part # 65-22774