

NEW AIRBRUSH KIT



AOM Spray Equipment
5005 Sanbusco Dr. NE
Rio Rancho, NM 87144
Phone: 505-867-1946
Fax: 505-867-1948

AB1134K

GRAVITY AIRBRUSH KIT

**Gravity air brush, double action trigger for air and paint control.
Precision machined air and fluid nozzles.**

Color Applied

Watercolors, acrylics, dyes and inks

Kit Contains:

1 - Airbrush

1 - 8' 6" Hose with fittings

1 - Wrench

Fluid Nozzles - 1 - 0.3mm, 1 - 0.5mm and 1 - 0.7mm

Metal Cups - 1 - 2cc, 1 - 5cc with lid and 1 - 13cc with lid

PARTS DETAILS

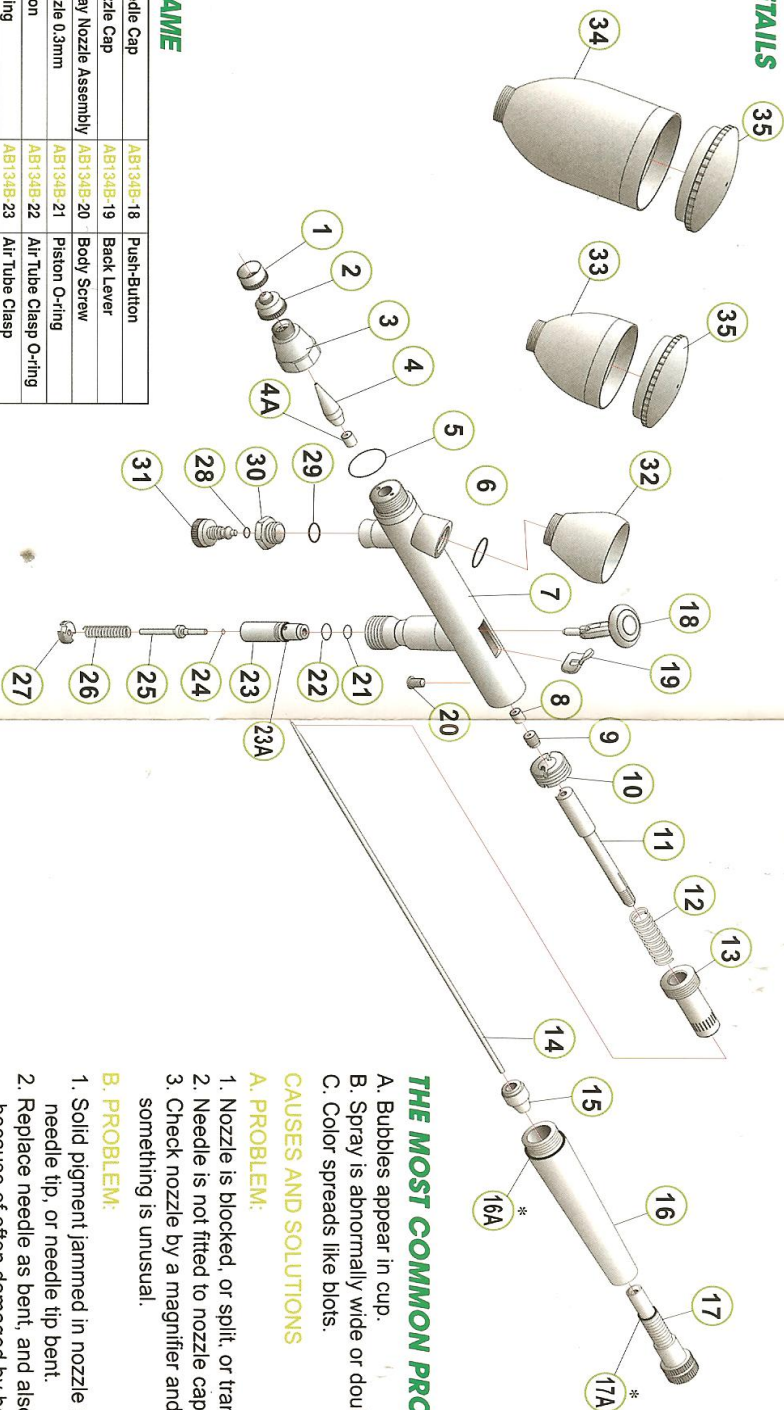

PARTS NAME		
AB134B-1	Needle Cap	AB134B-18
AB134B-2	Nozzle Cap	AB134B-19
AB134B-3	Spray Nozzle Assembly	AB134B-20
AB134B-4	Nozzle 0.3mm	AB134B-21
AB134B-4A	Teflon	AB134B-22
AB134B-5	O-Ring	AB134B-23
AB134B-6	O-Ring	AB134B-23A
AB134B-7	Body	AB134B-24
AB134B-8	Teflon O-ring	AB134B-25
AB134B-9	Teflon Stop Screw	AB134B-26
AB134B-10	Lock Screw	AB134B-27
AB134B-11	Needle Guide	AB134B-28
AB134B-12	Spring	AB134B-29
AB134B-13	Spring Stop	AB134B-30
AB134B-14	Needle 1.4mm	AB134B-31
AB134B-15	Needle Stop Screw	AB134B-32
AB134B-16	O-Ring	AB134B-33
AB134B-16A	Tail Cap	AB134B-34
AB134B-17	Needle Adjustor	AB134B-35
AB134B-17	O-Ring	

THE MOST COMMON PROBLEMS

- A. Bubbles appear in cup.
- B. Spray is abnormally wide or double pattern.
- C. Color spreads like blots.

CAUSES AND SOLUTIONS

A. PROBLEM:

1. Nozzle is blocked, or split, or transformed.
2. Needle is not fitted to nozzle cap and needle cap.
3. Check nozzle by a magnifier and replace it as something is unusual.

B. PROBLEM:

1. Solid pigment jammed in nozzle or stucked to needle tip, or needle tip bent.
2. Replace needle as bent, and also replace nozzle because of often damaged by bent needle.

C. PROBLEM:

1. Nozzle tip too close to work surface, or Push-Button drawn too much.
2. Keep Nozzle tip away, or press fully Push-Button and draw it slightly.

SPECIFICATIONS:

Double Action Airbrush:
AB134B: 0.3 mm

COLORS APPLIED:

Water color, acrylics, gouaches, dyes and inks.
* Additional purchase

HOW TO OPERATE

- A. Press Push-Button slightly or hard then a small or large amount of air emerges out of nozzle accordingly.
- B. After pressing Push-Button, draw it backward gradually for color atomization. Air brush gives fine-line spray to broad area in accordance with the degree of pressing and drawing push button as well as the distance between an air brush and a work surface.
- C. Stippling is achieved by removing the needle cap and nozzle cap and adjusting the air pressure.