

# USE AND MAINTENANCE MANUAL



## Mini Eco HVLP Spray Gun

(Rev. 1 - 07/14/04)  
USA - Mini Eco HVLP

A.O.M. Spray Equipment  
7289 Park Drive  
BATH, PA 18017

Cert. -04985-99-AQ-MIL-SINCERT

## TROUBLE SHOOTING

<u>PROBLEM:</u>	<u>CAUSE:</u>	<u>REPAIR:</u>
Gun leaks from tip	Foreign substance between fluid tip and needle	Clean needle and nozzle
Paint emerges from fluid needle packing	Self tensioning needle packing is damaged or lost	Replace needle packing
Spray pattern in sickle shape	Horn air holes or air cap clogged	Soak air cap in thinner and clean with cleaning needle
Drop-like or oval shaped pattern	Dirt on fluid pin or air cap	clean fluid tip pin and air cap
Spray flutters	Cup vent clogged, or nozzle clogged	Clean
Material bubbles in cup	Fluid nozzle is loose	Tighten

ITEM#	DESCRIPTION
61-2016	Trigger Pin
61-2017	Snap-Ring
61-2018	Fluid Control Knob
61-2019	Lock to Fluid Control Knob
61-2020	Spring for Paint Needle
61-2021x	Paint Needle
61-2022	Washer
61-2027	Air Valve Assembly
61-2028	Screw
61-2029	Control Knob
61-2030	Fan Control Assembly
61-1931	Air Connection Piece 1/4" NPS
61-1733	Air Adjusting Valve Assembly
61-2637	Regulator
61-2601x	Air Nozzle w/brass cap
61-2004	O-Ring
61-2605	Gun Body
61-2005x	Fluid Nozzle
61-2007	Gasket
61-2008	Packing Screw
61-2009	Teflon Seal
61-2009A	Spring
61-2010	Connector
61-1727	Material Sleeve
61-1730	Wrench
61-1732	Brush
61-2011	Plastic Cup with Graduation
61-2012	Cover
61-2013	Trigger
61-2014	Snap-Ring
61-2015	Screw

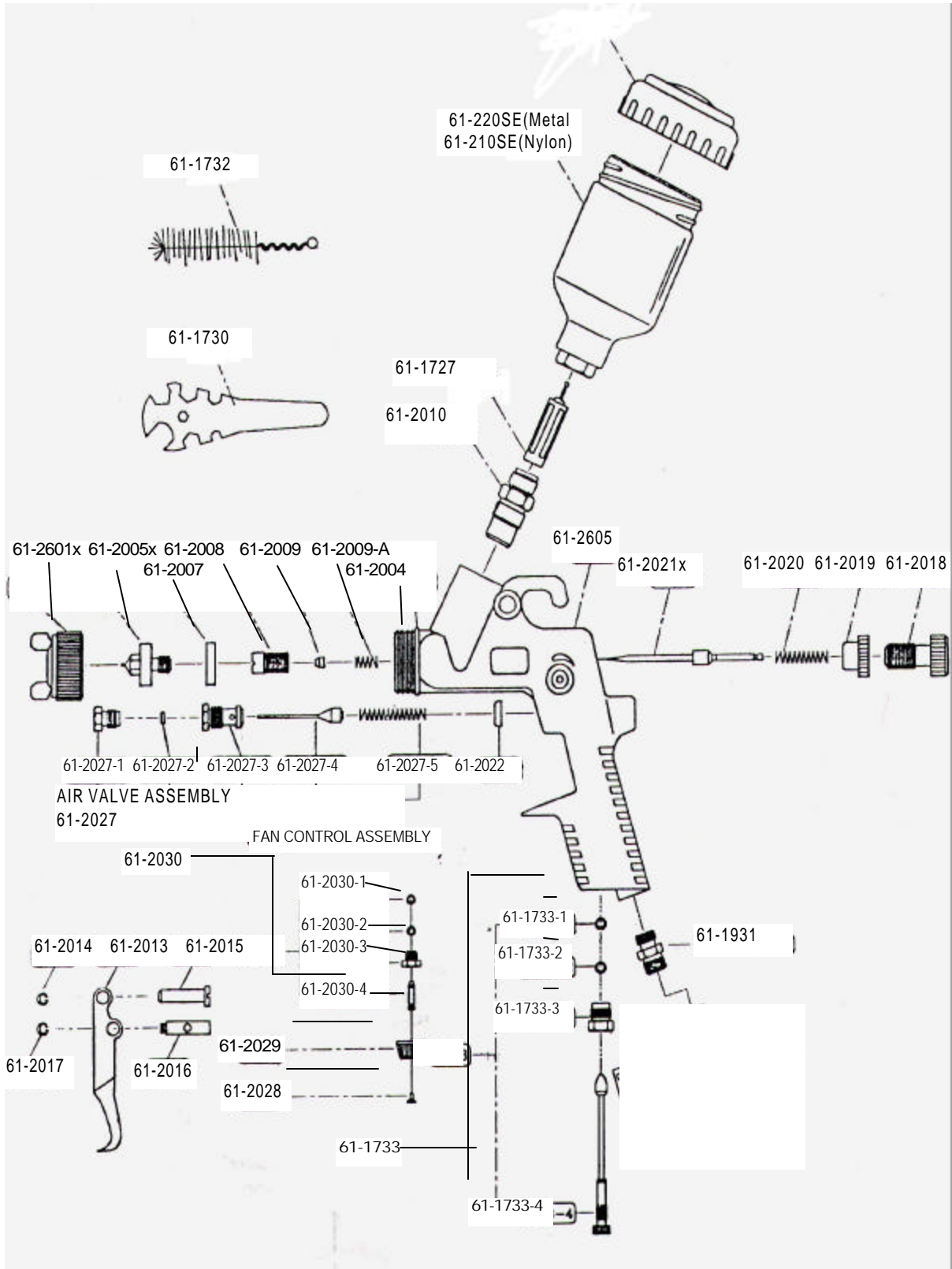

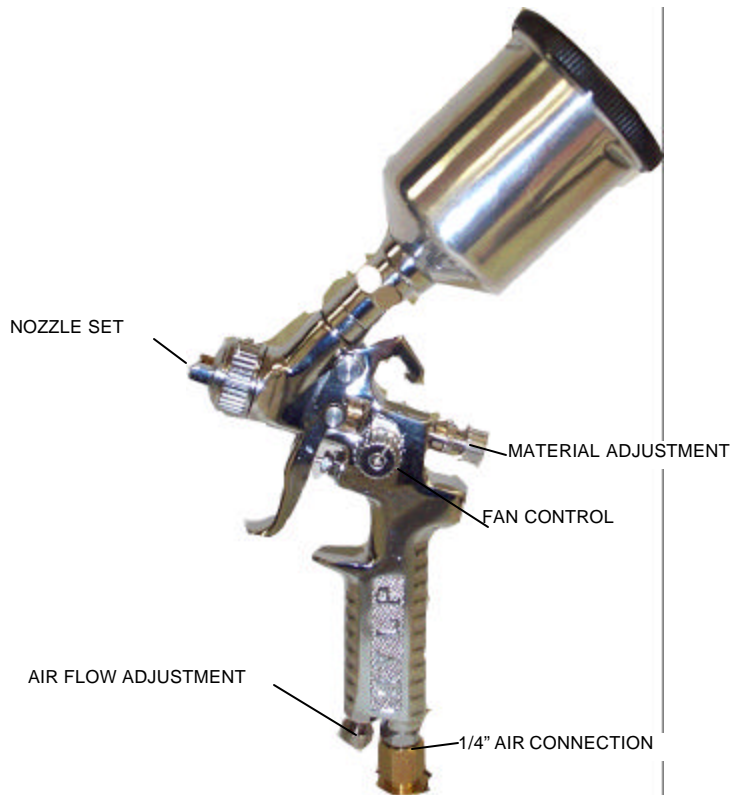

**COMPLETE KIT WITH GUN, HOSE, 200 cc STAINLESS STEEL CUP, 4 MINI GLASS CUPS, WRENCH AND BRUSH**

**SPECIALLY DESIGNED AIRCAP MINIMIZES OVERSPRAY**

**QUALITY OF SPRAY COMPARES TO  
CONVENTIONAL HIGH  
PRESSURE GUNS**

- 61-2xx**      *MINI ECO HVLP GRAVITY GUN KIT*  
                   (replace xx with tip size: 0.8, 1.0, or 1.2)  
 INCLUDES GUN, 200 cc. STAINLESS STEEL CUP WITH FILTER AND LID, 4 MINI  
 GLASS CUPS, HOSE, WRENCH, BRUSH AND CARRYING CASE
- 61-2006x**      *NEEDLE NOZZLE AIRCAP KIT* (replace x with tip size: 0, 1, or 2)
- 61-210SE**      *150 cc. NYLON CUP w/LID ONLY*
- 61-220SE**      *200 cc. STAINLESS STEEL CUP w/LID ONLY*
- 61-2000R**      *Seals and Spring Repair Kit*  
                   *(includes parts #2004, 2007, 2009, 2009A, 2020, 2027)*